

TOWN OF WESTON COMMUNITY PRESERVATION COMMITTEE
Project Submission Form – FY19
Summary Form

Submission Date: January 16, 2018, Revised January 25, 2018

Project Name: Case Park Restoration and Rehabilitation

Project Address: Case's Corner, School Street and Wellesley Street

Brief Project Description: This project implements the design (initiated under CPC admin funds in FY'17) for a long-needed restoration of this historic park in the geographic center of our town. Following the poor results of soil testing done in 2017, the design includes the removal of dead or dying trees and shrubs, removal of compacted topsoil crust throughout the park, enrichment with compost and mulches, and installation of irrigation pipes, before new trees and shrubs are installed (see plan from Tom Wirth attached). A memorial plaque, stolen long ago, will be restored on its granite base ~~and protected by a new cedar structure with benches, custom designed and built to enhance this park.~~ All dead and dying trees and shrubs will be carefully replaced with native species chosen for long-lasting ecosystem value and low-maintenance. Special consideration will be given to planning for the Weston Scouts' seasonal activities and to a restored pedestrian entrance for the surrounding residential neighborhood, with outreach meetings to various groups planned for spring 2018.

Contact Person: Laura Perry, MD

Contact Title: Member, Weston Tree Advisory Group

Contact Phone #: 617-893-2008

Contact Email Address: drljerry@gmail.com

Contact Mailing Address: 10 Kingsbury Lane, Weston, MA 02493

Sponsoring Organization (e.g., Conservation Commission): Tree Advisory Group

Eligibility - Only activities designated in "Yes" boxes, below, are eligible uses of CPA Funds. Please mark the box, or boxes, that apply:

	Open Space	Historic Resources	Recreational Land	Community Housing
Acquire	Yes	Yes	Yes	Yes
Create	Yes	No	Yes	Yes
Preserve	Yes	Yes X	Yes X	Yes
Support	No	No	No	Yes
Rehabilitate and/or Restore	Yes, if acquired or created with CPA funds	Yes-X	Yes -X	Yes, if acquired or created with CPA funds

Projected Cost (Please add information for additional fiscal years as necessary):

Fiscal Year	Total Project Cost	CPC Funds Requested	Other Funding Sources (amount and source)
2018 (prior yr.)		7,500	
2019		45,117	DPW: 8,775
2020			
2021			
Total:		52,617	61,392

**TOWN OF WESTON COMMUNITY PRESERVATION COMMITTEE
Project Submission Form – FY19
Application**

Please address the following questions/categories using additional sheets as necessary.

- Goals/Community Need:** What are the goals of the proposed project? Who will benefit and why? Does the project address needs identified in existing Town plans?

The goals of this project include the restoration and revitalization of a neglected horticultural park in the center of town, which was originally a historic gift. Replacement/replanting of dead or failing trees and shrubs following improvement in the underlying soil substrate will make for a more beautiful and ecologically sound preserved open space. This is meant for the enjoyment all of residents, whether they be pedestrians walking through (passive recreation) or drivers passing by. Perhaps scouts and their families will benefit most directly.

- Project Timeline:** Describe project milestones and when they will be completed.

See attached.

- Community Support:** Describe the nature and level of support for and/or opposition to this project. In particular, describe which Town Boards/Committees/Departments or community organizations you have consulted/collaborated with.

As Case Park is in direct continuity with land at the Scout House, this project has been discussed with them and has their support. John Zaccardi from the DPW is aware of this proposal and is working with TAG to both install and care for the large center grass area, and possibly also be involved with other early maintenance. TAG will also be presenting this plan to the Weston Garden Club, the CPC and abutting neighbors to get further community feedback. This project will be presented to the Recreation Commission on January 25th.

- Budget:** Provide a line item budget and an explanation of how the budget was prepared. Include back up documentation including any proposals for services, professional cost

estimates, etc. For community housing development projects, provide a phased sources and uses of funds.

See attached.

- 5. Other Funding Sources:** In addition to CPA Funds, what other funding sources are available, committed, or under consideration? Include commitment letters, and describe any other attempts to secure public or private funding for this project.

DPW - \$8,775 budgeted for this project.

- 6. Implementation:** Identify the person/persons responsible for project implementation and describe his/her/their relevant experience.

Tom Wirth- landscape design

Mark Fiely: Ernst Seed Co.

Tree Specialties Inc, Holliston, MA

Tom Cullen/John Zaccardi/DPW

TAG

- 7. Comparable Projects:** List and describe any comparable projects.

Eversource Street tree replacement plantings on North Ave and Newton Street and Maple alley on Wellesley St (2017), Rt 30 intersection Trees (2017), Fiske ark Triangle

- 8. Operations/Maintenance:** If the project is revenue generating, provide a 5 year operating budget. If the project will not generate revenue but ongoing maintenance will be required, provide a 5 year budget with funding sources identified. (CPA funds cannot be used for maintenance). Identify the person(s)/entity responsible for operations/maintenance.

N/A—no plans for this to generate revenue; DPW and TAG will maintain.

- 9. Multiple Projects:** Sponsors with multiple proposals should prioritize them.

10. Provide Supporting Documentation as Applicable:

- a. Evidence of Site Control (e.g., purchase and sale agreement);**
- b. Feasibility Studies;**
- c. Letters of Support;**
- d. Maps;**
- e. Statistics; and**
- f. Other Relevant Information.**

Case Park Restoration and Rehabilitation - Budget for FY 2019

Installation of Trees and Shrubs	15 trees	63 shrubs	Includes purchase, prep, planting	24,182.
Native Pollinator Garden in monument circle/ Replace bronze	Drought tolerant Hummingbird and butterfly garden plugs	Prep and plant Plus bronze plaque	\$129/tray=2064. est \$2000.00 for plaque	4,064.
Tree & Shrub removal, stump grinding, transplanting	11 dead/dying trees	7 invasive shrubs		5,581.
Forest Floor Treatment	Remove existing grasses/weeds	Apply amendments	Seed meadow mix with drought tolerant fescue	9,290.
Install permanent irrigation heads	100' pipe and lockable faucet on each side of park			2,000.
Total Projected Cost				45,117.

	2015	2016	2017	2018	2019
Jan		*	* ^	O	
Feb		*	*	O	
Mar		*	*	O	
Apr		*	*	A O	A
May		*	*	\$ O +	
Jun	Site surv	*	*	\$ O +	
July	CPC\$	*st	*	\$ i O +	
Aug	*	*st	* O	i O +	
Sept	*	*st ^	* O	# i	
Oct	*	* ^	* O	#	
Nov	*	* ^	* O		
Dec	*	* ^	* O		

- *= landscape design
- A= arbor day planting
- st=soil testing
- ^ =topographical survey

- \$ = procurement
- + = layout/soil prep
- O = outreach
- # = planting
- i = irrigation

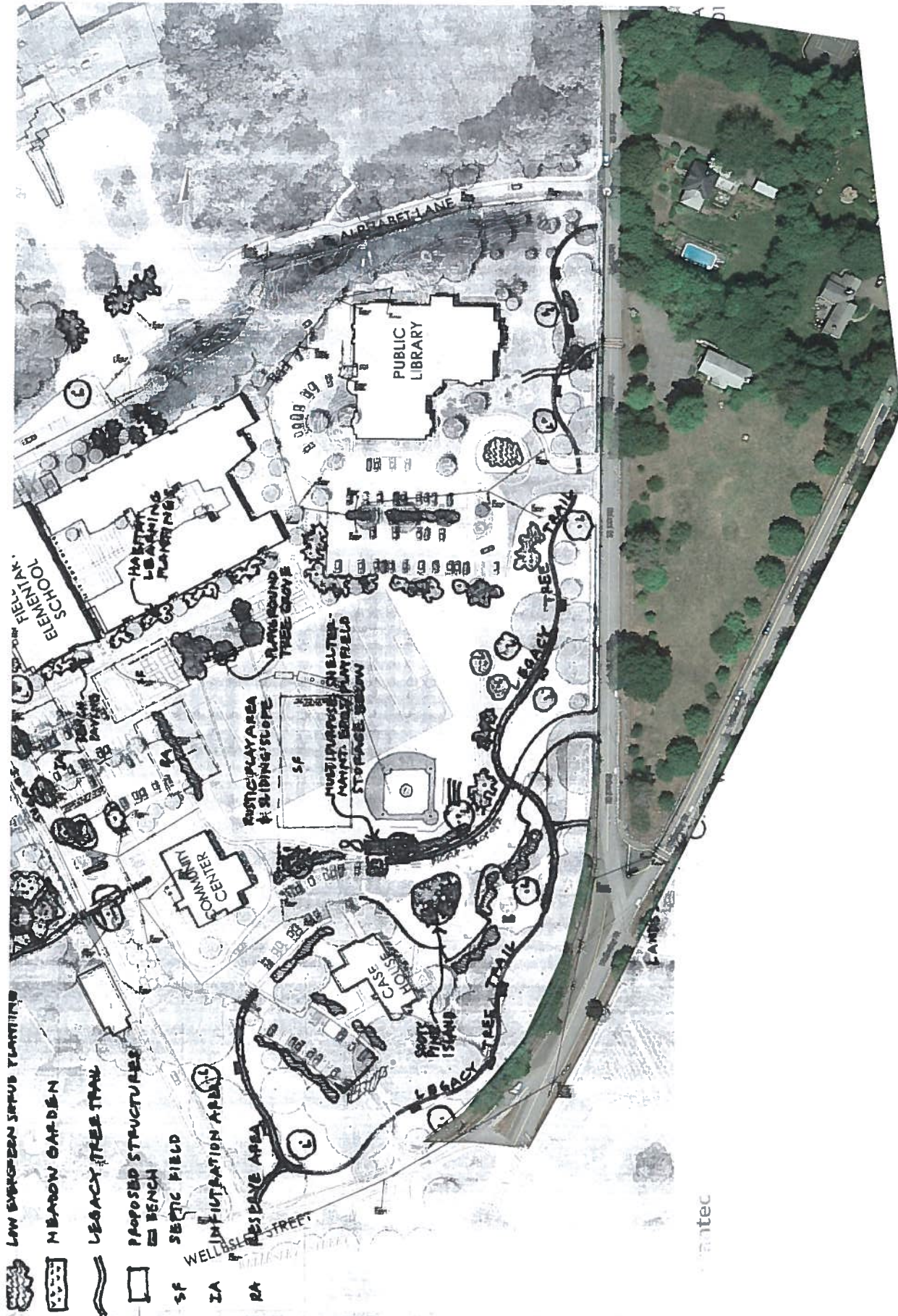

LOW EVERGREEN SHRUB PLANTING

MEADOW GARDEN

LEGACY TREE TRAIL

PROPOSED STRUCTURES

BENCH

SEPTIC FIELD

SF

IA

RA

ELEMENTARY SCHOOL

HANDICAPPED PLAYGROUND

PURPOSE-BUILDING TREE GROVE

RESTROOM AREA & SLIDING SCOPE

MULTIPURPOSE ANCHOR - MAINT. BENCH PLAYFIELD STORAGE ROOM

COMMUNITY CENTER

CASE HOUSE

SOFT PLAY ISLAND

LEGACY TREE TRAIL

PUBLIC LIBRARY

ALPHABET LANE

WELLSLIDE STREET

Antec



Horticultural Consulting Report

Date November 10, 2017
Site Case Park
To Tom Wirth, Thomas Wirth Associates
From Barbara Keene Briggs
Subject Forest Floor and Open Lawn

Assignment

Explore ground plane treatments as proposed by Tom Wirth, Thomas Wirth Associates (TWA), in terms of species selection, maintenance and cost benefits.

Approach

The total area within the project scope is 2 acres. 3/4 acre of the property is proposed as "Forest Floor Zone." This portion will be located around the perimeter of the property. The intent of developing a forest floor zone is to cultivate a favorable condition for the trees and shrubs while providing opportunity for enhanced aesthetics, seasonal interest and ecological benefits. Two options are proposed for this zone. The first is a blend of wildflowers and grasses, the second is simply an autumn grass. One of the major factors in plant selection is choosing plants that stay approximately two feet in height.

The remaining 1.25 acres include the open lawn (including the scouts lawn space) comprised of a short fescue blend that is drought tolerant and requires less mowing than conventional turf grass blends. This blend can be mowed at two inches high or it can be left to grow into a longer, softer, more pastoral effect. Currently the existing lawn is primarily a fescue blend which is appropriate for the existing soil type and is easy to modify without having to renovate the entire open lawn area.

Key Considerations

- Establishment of the forest floor zone will require turf removal in order to achieve the desired intent. In doing so, extra care will be needed to not injure the root systems of the mature trees.
- The most effective time to install this project is late August/early September when nights are cooler and rainfall is more frequent. It also allows time for the seed to establish prior to winter. Alternatively, the installation could occur in late winter/early spring when rainfall is still abundant and weed competition is not a factor.

Soil Amendments

Create a favorable soil condition for the woody plants by adjusting the pH to 6.0 in order to maximize nutrient uptake. The materials, application rate and timing will be formulated based on the seven soil tests collected in the fall of 2016. The pH for the site is very low with an average of 4.6pH. Total amendments needed:

- 25,177 lbs Lime
- 165 lbs K-Mag

The soil amendment treatment schedule:

Note: No more than 50 lbs of lime/1000sf should be applied in one treatment.

Spring 2018 – 4,356 lbs lime
165lbs K-Mag



Fall 2018 –	4,356 lbs lime
Spring 2019 –	4,356 lbs lime
Fall 2019 –	4,356 lbs lime
Spring 2020 –	4,356 lbs lime
Fall 2020 –	4,356 lbs lime

Open Lawn Establishment

Slice seed a short fescue existing lawn. Eco Lawn is a seed mix that contains a variety of short fine fescues (see attached label and/or visit their website at <http://eco-lawn.com/>)

The total square feet for the open is 54,450 sf. The application rate is 5lbs per 1,000sf. 5.5 50lbs bags would be required.



Forest Floor Establishment

Site Preparation:

- Cut down trees slated for removal and grind stumps.
- Herbicide method: spray glyphosate on all undesirable turf. For woody invasive plants, flush cut and swipe the cambiums with triclopyr to prevent resprouting. After 2 weeks, monitor and treat again if needed.
- Till method: Since the forest floor will be installed under existing mature trees, rototilling should only be used to scarify the upper one inch layer of soil. First till all recently sprayed turf. After 2 weeks, till again.
- Rake, grade and prepare the soil for seeding and planting.
- Plant trees and shrubs and coordinate watering so that the new plantings receive a minimum of 1.5" of water per week.
- Prior to seeding, loosen soil in order to establish seed-to-soil contact. Lightly rake over newly seeded areas to facilitate seed/soil contact to a ¼" – ½" depth.
- Note: Hydroseeding can help retain moisture and protect seed and soil until germination.

Seed Selection:

Utilize a combination of short grasses combined with flowers that offer seasonal interest. Utilize seed for dry upland conditions so the plants will be better able to survive/thrive during drought conditions.



Forest Floor: Option 1

%	Plant	Height	Color	Bloom
.5%	<i>Aquilegia canadensis</i> , Eastern Columbine	24"	Orange	Late Spring
2%	<i>Asclepias tuberosa</i> , Butterfly Milkweed	24"	Orange	Summer
2%	<i>Aster oblingifolius</i> , Aromatic Aster	12-24"	White	Summer to Fall
2%	<i>Chrysanthemum leucanthemum</i> , Oxeye Daisy	24-36"	White	Summer
8%	<i>Lineum perenne</i> , Perennial Blue Flax	18-30"	Blue	Spring to Summer
2%	<i>Matricaria recutita</i> , German Chamomile	18-24"	White	Summer
1%	<i>Papaver rhoeas</i> , Corn Poppy	12-30"	Variety	Summer
1%	<i>Rudbeckia hirta</i>	24-30"	Yellow	Summer to Fall
2%	<i>Veronica officinalis</i> , Veronica Speedwell	4-12"	Blue	Spring to Summer
.5%	<i>Viola odorata</i>	6"	Purple	Spring
35%	<i>Festuca ovina</i> , Sheep Fescue	6-24"		
30%	<i>Schizachyrium scoparium</i> , Little Bluestem	24-36"		
15%	<i>Festuca rubra</i> , Creeping Red Fescue	12-24"		
100%	Eco-Lawn (3' deep around road and lawn side)	2'		

First Growing Season Maintenance:

When the seed establishes and reaches a height of 18-24", use a brush mower to trim the meadow to 8 inches in height. A regular mower can't be used because the blades are too low and will kill the plant crowns. Maintaining this height will reduce competition with the more fast-growing species. Mowing should cease by mid-September.

Second and Subsequent Growing Seasons:

When new growth reaches 2 inches in height, mow previous season's growth to 4 inches in height. This allows the soil to warm more quickly which will stimulate the emergency and growth of herbaceous native plants, as well as help reduce invasive plant growth.

Forest Floor: Option 2

As an alternative to wildflowers, a single species planting of autumn bend grass is proposed. This species has beautiful seed heads in the fall and would show a clear delineation between the forest floor and the open lawn.

Gazebo Planting

For seasonal color and wildlife benefits, a garden comprised of plants that support our native pollinators and attract butterflies and hummingbirds will be planted around the Gazebo. This garden will be installed using plugs to maximize quantities at a lower cost than the conventional 2 quart or 1 gallon size plants. This is product available through Praire Moon Nursery, called BFLYDRY-T.

Case Park, Weston MA

Cost Projections

Plant Schedule for Trees and Shrubs						
Qty.	Common Name	Botanical Name	Size	Notes	Unit Cost*	Executed Cost
2	Red Oak	Quercus rubra	3-3.5"	Caliper	430	3,010
3	Witchhazel	Hamamelis intermedia 'Arnold's Promise'	3-4'	B&B	125	1,313
3	Dogwood	Cornus florida 'Cherokee Princess'	2/2.5"	Caliper	270	2,835
21	Inkberry	Ilex glabra 'Compacta'	#5	Container	39	2,867
10	Bayberry	Myrica pensylvanica	2/2.5"	B&B	43	1,505
3	Redbud	Cercis canadensis	2/2.5"	Caliper	285	2,993
1	Sourwood	Oxydendron arboreum	2/2.5"	Caliper	490	1,715
18	Summersweet	Clethra alnifolia 'Sixteen Candles'	#5	Container	39	2,457
3	Sweetbay	Magnolia virginiana	8-10'	B&B	340	3,570
3	Rhododendron	Rhododendron catawbiense 'Album'	2.5/3'	B&B	69	725
11	Chokeberry	Aronia arbutifolia 'Brilliantissima'	2/3'	B&B	31	1,194
						24,182
Plant Schedule for Native Pollinator Garden around Gazebo						
4	Butterfly & Hummingbird Garden Plugs for dry soil (Prairie Moon Nursery)		38/tray	plugs	129	2,064
						2,064
Lawn Seed Blend						
6	Eco-Lawn Seed and soil amendements based on soil test results (year one)		50 lbs	bags	399.99	8,775
						8,775
Tree & Shub Removal, Stump Grinding and Transplanting						
	Euonymous	Euonymus sachalinensis - Cut down/grind stump				370
	Barberry	Berberis sp. - Cut down/grind stump				230
	Sugar Maple	14" Acer saccharum - Cut down/grind stump				688
	Dawn Redwood	14" Metasequoia glyptostroboides - Cut down/grind stump				688
	Dawn Redwood	10" Metasequoia glyptostroboides - Cut down/grind stump				460
	Sugar Maple Stump	Grind stump				220
	Apple	12" Malus multi-stem - Cut down/grind stump				311
	Hemlock Stump	Grind stump				425
	Apple	12" Malus multi-stem - Cut down/grind stump				311
	Serviceberry	10" Amelanchier canadensis - Cut down/grind stump				289
	Royal Azalea	5- High x 6' Wide - Transplant				354
	Dead tree	Cut down suckers and grind stump				125
	Azalea and Euonymous	Cut down and grind stumps				168
	Hemlock Stump	Grind stump				440
	Bittersweet on Taxus	Cut bittersweet and swipe stems to prevent resprouting				188
	Dogwood	6" Cornus florida - Cut down/grind stump				185
	Burning bush	Euonymus alatus - Cut down/grind stump				129
						5,581
Tree Stabilization						
	Tuliptree	36" Liriodendron tulipifera - Install lighting protection				2,400
		Prune for crown cleaning and endweight reduction on heavy limbs				1,600
						4,000
Forest Floor Treatment						
Spray existing grass to remove undesirable vegetation/grasses						475
Apply amendements based on soil test results. (year one)						1,575
Prepare area for seed						5,932
Option 1: Meadow mix with fescue						436
Option 2: Autum Bent Grass (\$17/lb @ 20lb/acre)						340
						10,650
Total Project Cost						55,252



Wildflower Farm
Natural Landscaping Solutions
Since 1988

[Seed Finder](#)

Categories

[Eco-Lawn](#)[Seed Mixes](#)[Wildflower Seed](#)[Native Grass Seed](#)[Seed Selector](#)[How to Grow a Meadow](#)[Monarch Favourites!](#)[Sow & Grow!](#)[Moss Milkshakes](#)[Meadow Movie Magic!](#)[Garden Design Tips](#)[Starting Flower Seeds](#)[Gift Certificates](#)[Tours & Talks](#)[Plant Zone Map](#)

Got Shade?
Grow Moss!

**Moss Milkshake****34.95**[Add to Cart](#)

What is Eco-Lawn?

Introduced to the market in 1998, Eco-Lawn is a proprietary blend of fine fescue grasses that produce a healthy thick green lawn with minimal care. The varieties of fine fescue selected for Eco-Lawn have specific qualities that make them ideal for a low maintenance turf:

- Fast germination and early spring green-up
- Slow growing - reducing mowing by 50%
- Highly drought tolerant, reducing irrigation needs between 50-100%
- Develops deep roots to source water and nutrients naturally
- Grows well in full sun, part shade and deep shade
- Naturally occurring endophytes for increased insect resistance
- Little to no fertilizers required
- Rich dark green colour
- Salt tolerant

What is in Eco-Lawn?

Eco-Lawn is comprised of the following certified fine fescue grasses:

- **Shoreline Creeping Red Fescue**
This unique fine fescue has both salt tolerance and Rapid Blight resistance. Slender Creeping Red Fescue has a dark green colour, short rhizomes for repair and dense turf with winter-active growth and it is endophyte-enhanced for increased resistance to many

[Eco-Lawn](#)[Eco-Lawn Retailers](#)[What is Eco-Lawn?](#)[Customer Photos](#)[See Eco-Lawn Near You!](#)[How to Grow Eco-Lawn](#)[Eco-Lawn FAQ](#)[Key Benefits](#)[Water Savings Calculator](#)[How Much Seed Do I](#)[Need?](#)[Testimonials](#)[Eco-Lawn Videos](#)[Suggested Uses](#)[Seeding Times](#)[Common Lawn Weeds](#)[Diagnose Lawn Problems](#)

Insects and improved stress tolerance. It has excellent heat and drought tolerance and improved resistance to many diseases including Leaf Spot, Pink Patch, Summer Patch and Dollar Spot.

- **SR5250 Creeping Red Fescue**
Creeping Red Fescue is a highly adaptable because it thrives in both sun and shade with little to no irrigation. Being a "creeper" it helps fill in damaged areas of turf and binds the bunch grasses together to form a dense sod. Creeping Red Fescue, the most drought tolerant of the fine fescues, also contains an endophyte strain that has been closely correlated with Dollar Spot resistance. It performs well in high heat and under reduced maintenance making it an excellent low maintenance turf.
- **SR3150 Hard Fescue**
Hard Fescues are bunch forming grasses that are among the most heat and drought tolerant of all fine fescues. Forming an attractive, dark green, dense turf requiring minimal water and fertilization in both sun and shade, Hard Fescues grow slowly reducing or eliminating the need for regular mowing. Hard Fescues contain high levels of viable endophyte which has been shown to provide resistance to a number of turf insects including billbugs, sod webworms, chinch bugs and armyworms. In addition, Hard Fescues have high levels of resistance to many turfgrass diseases including Red Thread, Summer Patch, Dollar Spot, Leaf Spot and Powdery Mildew. Hard Fescues are also the most tolerant of heavy foot traffic of the fine fescues.
- **SR3210 Blue Fescue**
Blue fescue is a fine-textured, bunch type grass that is low growing with a blueish colour. Very stress and shade tolerant, Blue fescue thrives under the dry shade of trees while

What is Eco-Lawn?

persisting in full sun. It needs little or no fertilizer and has low water requirements after establishment which makes it ideal for a low maintenance turf perfect for environmentally sensitive sites. The waxy leaf covering, that contributes to the blue colour, reduces water loss so the grass can survive extended droughts. The foliage is not taller than 12 inches so mowing only needs to be done to remove seedheads in late spring. In warm climates, it has good winter colour and may even look greener during this period.

- **SR5130 Chewings Fescue**
This bunch grass has the deepest green colour of the fine fescues and makes a very high quality turf. It is also the most competitive of the fine fescues helping to crowd out weeds. Chewings Fescue thrives in acidic soils, such as those found under conifer and oak trees and its low growth and stress tolerance makes it great low maintenance choice. Chewings Fescue contains high levels of viable endophyte which provides natural insect resistance and improved stress tolerance in adverse environmental conditions

What makes Eco-Lawn different?

Unlike almost all the other grass seed available to the homeowner which contains only "common" seed, Eco-Lawn is comprised of 100% pure golf course quality "Certified" seed.

To be classified as "Certified" seed, the seed must:

- Be field inspected by an accredited certifying agency
- Be clean and free of noxious weeds
- Be bred and selected for improved performance

What is Eco-Lawn?

- Be blended and packaged in an accredited facility
- Be tested for purity and germination by an independent accredited seed analyst
- Not contain "other" crops
- Have a minimum germination rate of between 85 - 90%

Certified seed is your assurance of Quality. Eco-Lawn is Certified Seed.

**Experience what thousands of people across North America already know -
Grow an Eco-Lawn!**

We ship throughout North America.
Our customer service centre and technical support team is available Monday - Friday 8 am - 4 pm EDT.
1 866 476 9453

Information

**Ordering
Information
Privacy Policy
Terms &
Conditions**

**Customer
Service**

**Contact Us
Returns
Site Map**

Wildflower Farm © 2017



Search over 700 natives ...



PRAIRIE MOON[®] NURSERY

BUTTERFLY & HUMMINGBIRD GARDEN - FOR DRIER SOILS

BLOOM TIME/COLOR	SPECIES -	PLANTS/ KIT
Summer	Anise Hyssop	3
Summer	Butterfly Weed	3
Fall	Smooth Blue Aster	3
Spring-summer	Prairie Coreopsis	3
Summer	Pale Purple Coneflower	3
Summer	Prairie Alumroot	2
Summer-fall	Button Blazing Star	3
Spring-summer	Bradbury's Monarda	3
Summer	Hairy Mountain Mint	2
Summer-fall	Orange Coneflower	3
Summer	Wild Petunia	2
Spring-summer	Ohio Spiderwort	3
	Little Bluestem	2
	Prairie Dropseed	3
	12 flowers, 2 grasses	38

** Please note: We may need to substitute appropriate species without notice in the case of unexpected greenhouse failures or sold out species later in the season.*



f (<http://www.facebook.com/sharer.php?u=https://www.prairiemoon.com/butterfly-and-hummingbird-garden-dry.html>)



(<https://twitter.com/share?url=https://www.prairiemoon.com/butterfly-and-hummingbird-garden-dry.html>)



(<https://pinterest.com/pin/create/button/?url=https://www.prairiemoon.com/butterfly-and-hummingbird-garden->